

Latimea danturii "h" per modul: 30 mm

Latimea totala "H" per modul: 50 mm

Unghi de angrenare: 20°

Material: otel C45E-UNI EN 10083-1

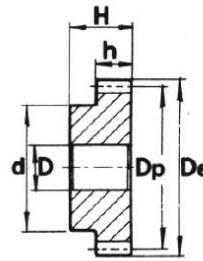
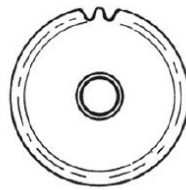

Z (numar de dinti)	Cod	De (mm)	Dp (mm)	d (mm)	D (mm)
12	PM 30012	42	36	25	12
13	PM 30013	45	39	25	12
14	PM 30014	48	42	30	12
15	PM 30015	51	45	35	12
16	PM 30016	54	48	38	15
17	PM 30017	57	51	42	15
18	PM 30018	60	54	45	15
19	PM 30019	63	57	45	15
20	PM 30020	66	60	45	15
21	PM 30021	69	63	45	15
22	PM 30022	72	66	50	15
23	PM 30023	75	69	50	15
24	PM 30024	78	72	50	16
25	PM 30025	81	75	60	16
26	PM 30026	84	78	60	16
27	PM 30027	87	81	60	16
28	PM 30028	90	84	60	16
29	PM 30029	93	87	60	16
30	PM 30030	96	90	60	16
31	PM 30031	99	93	70	20
32	PM 30032	102	96	70	20
33	PM 30033	105	99	70	20
34	PM 30034	108	102	70	20
35	PM 30035	111	105	70	20
36	PM 30036	114	108	70	20
37	PM 30037	117	111	80	20
38	PM 30038	120	114	80	20
39	PM 30039	123	117	80	20
40	PM 30040	126	120	80	20
41	PM 30041	129	123	90	20
42	PM 30042	132	126	90	20
43	PM 30043	135	129	90	20
44	PM 30044	138	132	90	20
45	PM 30045	141	135	90	20

Z (numar de dinti)	Cod	De (mm)	Dp (mm)	d (mm)	D (mm)
46	PM 30046	144	138	90	20
47	PM 30047	147	141	90	20
48	PM 30048	150	144	100	20
49	PM 30049	153	147	100	20
50	PM 30050	156	150	100	20
54	PM 30054	168	162	100	20
55	PM 30055	171	165	100	20
56	PM 30056	174	168	100	20
57	PM 30057	177	171	100	20
60	PM 30060	186	180	100	20
62	PM 30062	192	186	100	20
65	PM 30065	201	195	100	20